

AZIMUT
Grande

TRIDECK



PRELIMINARY PHOTO PRESENTATION

TRIDECK

THREEDecks+ONE

The very quintessence of innovation, Azimut Grande Trideck features a new living area, never seen before on a yacht this size: the Sea View Terrace.

As the latest addition to the traditional triple-decker, the Sea View Terrace is an aft raised "mezzanine" deck. Thanks to this layout innovation, Grande Trideck offers four terraces, completing a visual effect of cascading terraces from the Sundeck down to the sea.







TRIDECK

THREEDecks+ONE











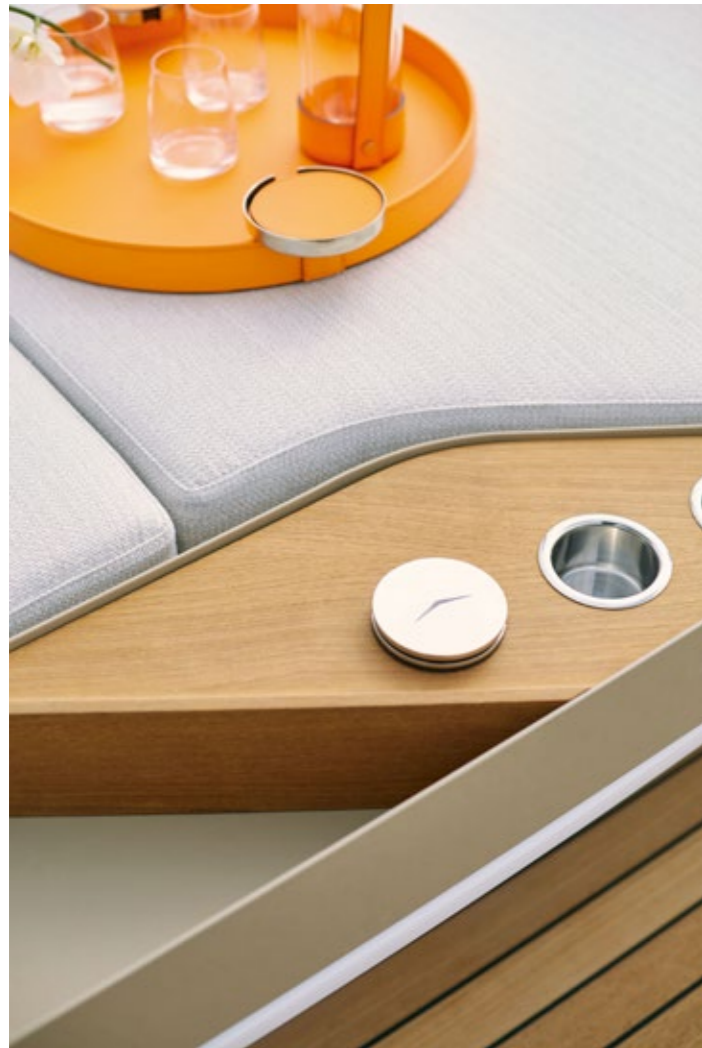



Simply Magnificent

The very quintessence of innovation, Azimut Yachts' first ever Trideck superyacht defies the accepted norms of boat design to create extraordinary new spaces that redefine the concept of onboard living.

With dimensions like never before and a design that breaks all the rules, the Grande Trideck is the magnificent new Azimut Yachts flagship.

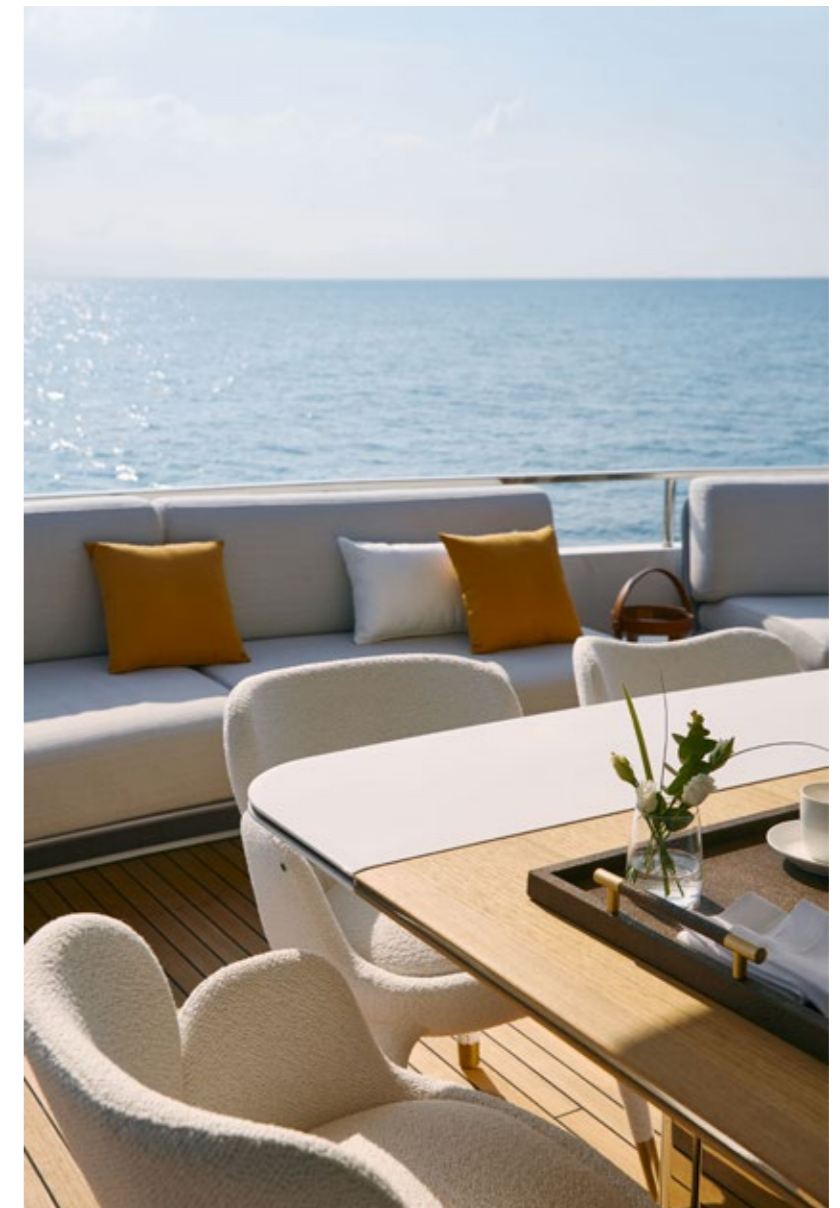













AZIMUT GRANDE TRIDECK

LOOK OUT
AT THE
OPEN WATER







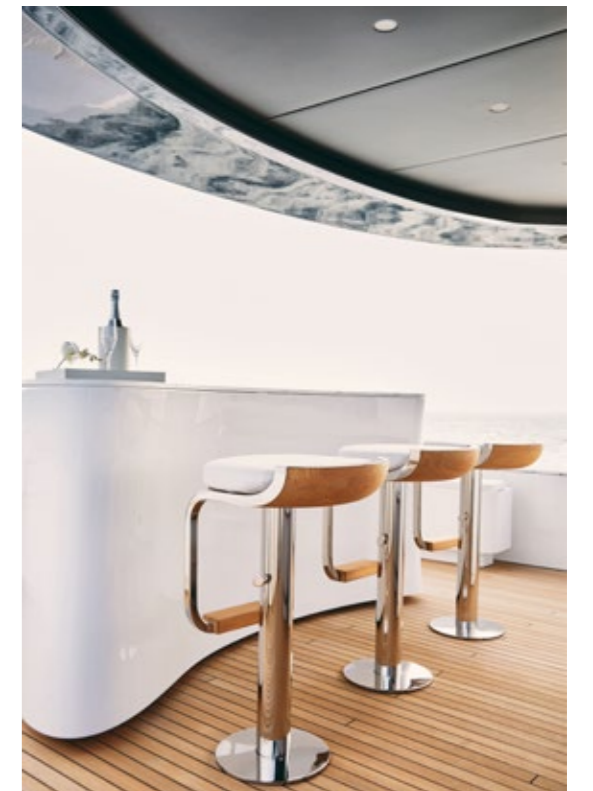











AZIMUT GRANDE TRIDECK

THE NEW
GENERATION
OF SUPERYACHT



















TRIDECK

THREEDecks+ONE

Spatial composition is the guiding principle of the interiors of the Azimut Grande Trideck with architect Achille Salvagni eschewing pure décor and creating a new way of living on board spaces. Painstaking research lies behind even the smallest detail, with all coming together to create a soothing atmosphere of complete and total relaxation.























6th cabin on the upper deck





Thanks to a software called Simrad Command operating Grande Trideck is incredibly simple.

Azimut Yachts worked directly with partners Simrad and Sea Energy to integrate every onboard system: engines, pumps, generators, batteries, anchor, climate, lights, and appliances can be monitored and controlled from the helm. With custom installation on every yacht, the functionality is tailor-fit to the needs of this Trideck in her particular configuration. You can even monitor the temperature in the fridge.

Furthermore, thanks to the close communication between Simrad and the Smart Boat Home Automation mobile app from Crestron, the guests can access useful features as well – such as the AV system, climate control, lights and blinds to name a few.



TRIDECK

THREEDecks+ONE

Azimut Grande Trideck features a new living area never seen before on a yacht this size, the Sea View Terrace. The Sea View Terrace is an aft raised "mezzanine" deck, which is the latest addition to the traditional triple-decker.

Thanks to this layout innovation, Grande Trideck offers four terraces: the sundeck¹, perfect for secluded sunbathing, then the upper deck, where we find the main Outdoor Dining Area², next, the new Sea View Terrace³, floating just a few meters above the water, and down below, the full-height beach area⁴. Furthermore, one additional benefit of the aft raised "mezzanine" deck is the creation a Private Patio⁵ at the entrance to the salon, perfect to enjoy a complete privacy.

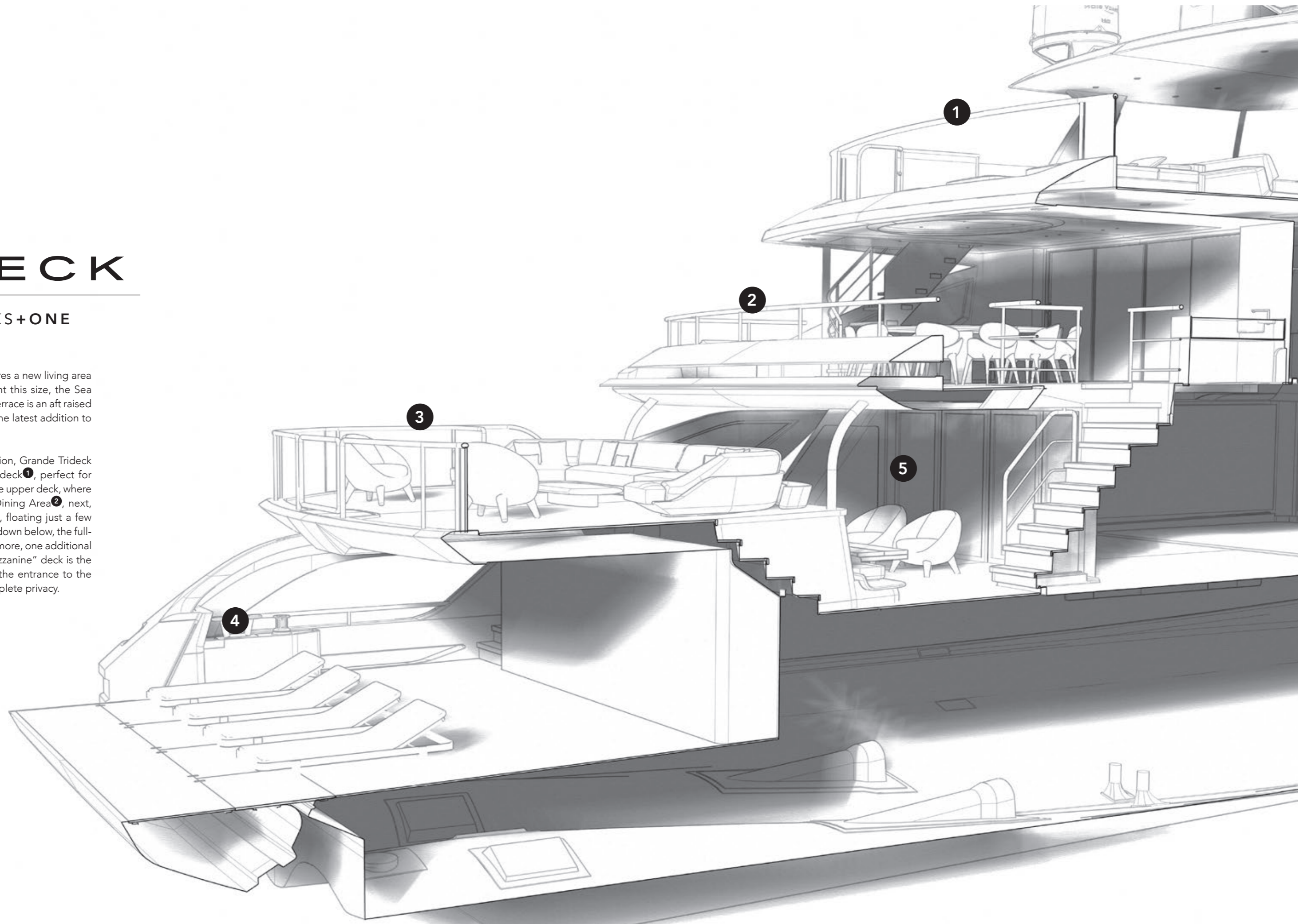



HOTEL MODE

Hotel Mode is just the simplest definition of an otherwise sophisticated and ingenious innovative way to enjoy time at the anchor at zero emission in the most peaceful silence nature can offer.

In Hotel Mode on board systems are fed by dedicated lithium ion battery packs in lieu of generators for up to 4 hours during the day and up to 8 hours at night, when the electrical power need of the yacht naturally decreases (range varies depending on weather conditions as well as personal use of electrical loads).

Hotel Mode is just the simplest definition of an otherwise sophisticated and ingenious innovative way to enjoy time at the anchor at zero emission in the most peaceful silence nature can offer.

While in Hotel Mode on board systems are fed by dedicated lithium ion battery packs in lieu of generators for up to 4,8 hours during the day and up to 7 hours at night, when the electrical power need of the yacht naturally decreases (range varies depending on weather conditions as well as personal use of electrical loads).

HULL INNOVATION

The D2P Displacement to Planing® hull designed by Pierluigi Ausonio in conjunction with the Azimut Benetti Research Development centre, combines the comfort typical of a displacement hull with the performance of a planing hull and a wave piercer to improve fuel efficiency.

The D2P hull with wave piercer means the yacht can reach high top speeds without needing particularly powerful engines, or navigate in displacement mode with a remarkable range at a cost effective speed.





CARBON TECH

The extensive use of carbon fiber, which Azimut Yachts has pioneered in all its collections, makes it possible to extend the space available without increasing the yacht's weight, resulting in better performance and unprecedented comfort onboard. Roll momentum can be decreased from 3% to 15%.

The Azimut Grande Trideck uses pure carbon fibre laminated with vinyl ester resin on flybridge, superstructure, radar arch, hard top, transom and platform.

-
- SUPERSTRUCTURE —
 - FLYBRIDGE —
 - UPPER FWD PART OF THE FLYDECK —
 - RADAR ARCH —
 - MAST —
 - HARD TOP —
 - TRANSOM/PLATFORM —
-

CARBON FIBRE —
 HYBRID —



MAIN TECHNICAL DATA

AZIMUT GRANDE TRIDECK

Length overall (incl. pulpit)	38,22 m (125' 5")
Beam max	7,98 m (26' 2")
Draft (incl. props at full load)	2,05 m (6' 9")
Displacement (at full load)	approx 190 t (418874 lb)
Engines	2 x 2400 mHP MTU 2 x 2600 mHP MTU
Maximum speed	up to 23 knots up to 24 knots
Cruising speed	up to 20 knots up to 21 knots
Fuel capacity	22500 l (5944 US Gal)
Fresh water capacity	4300 l (1136 US Gal)
Black water capacity	1530 l (404 US Gal)
Gray water capacity	1830 l (483 US Gal)
Cabins	5 + 4 crew 6 + 4 crew
Berths	10 + 6 crew
Head compartments	7 + 4 crew
Hull	D2P Displacement to planing hull
Exterior design	Alberto Mancini
Interior designer	Achille Salvagni Architetti
Hull designer	P.L. AUSONIO Naval Architecture & Azimut Yachts R&D Dept.
Construction material	Carbon fibre + GRP

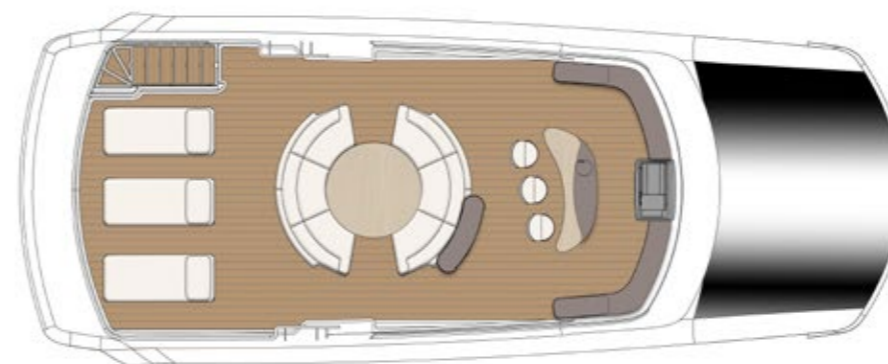

FLYBRIDGE

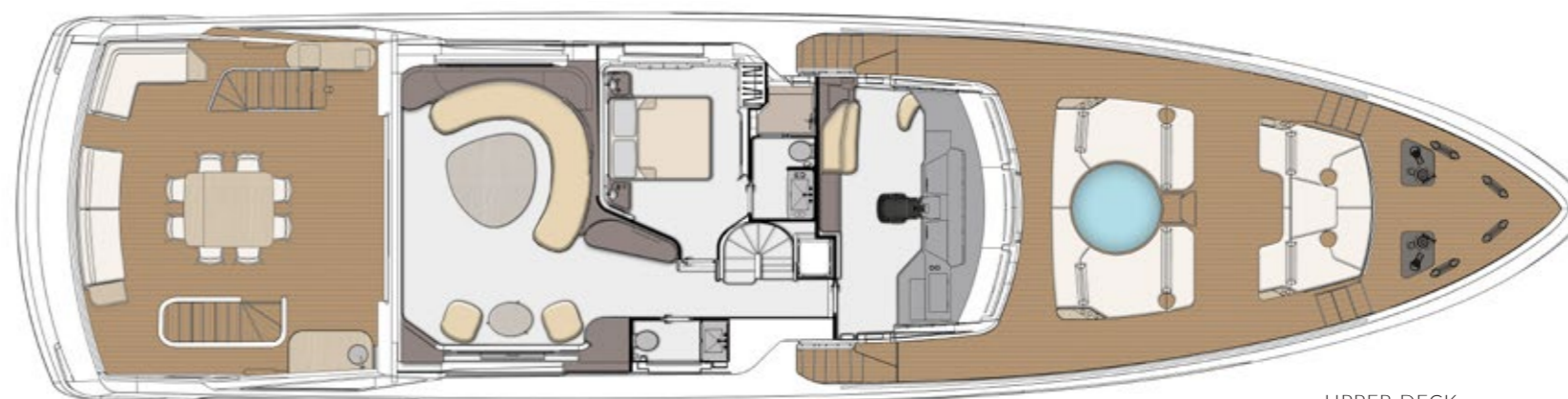

UPPER DECK

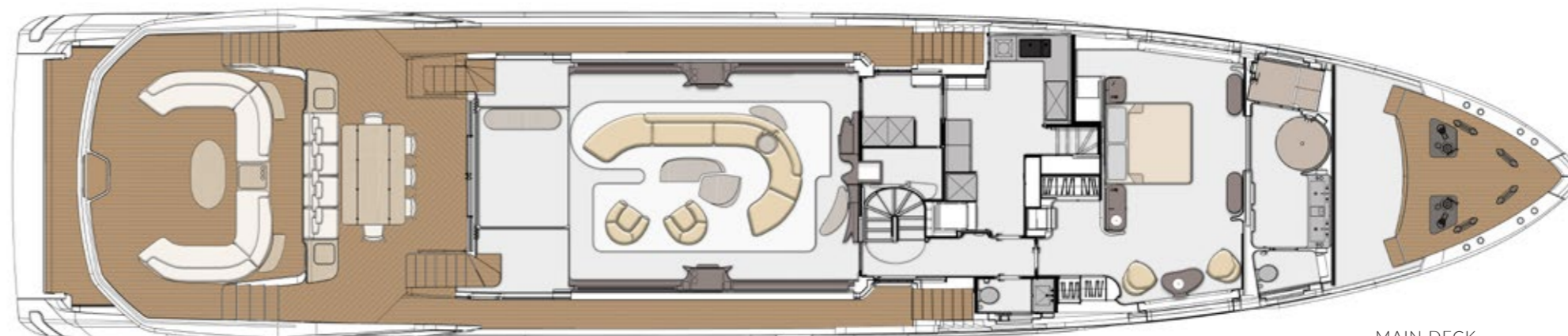

MAIN DECK



LOWER DECK

GENERAL ARRANGEMENTS STANDARD VERSION

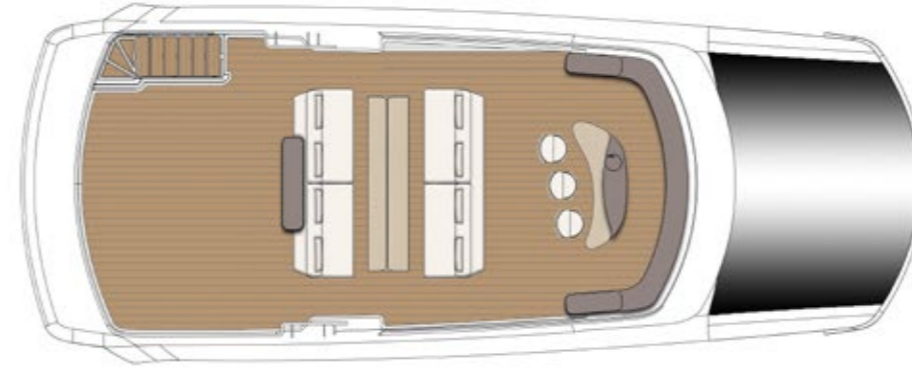

FLYBRIDGE



UPPER DECK

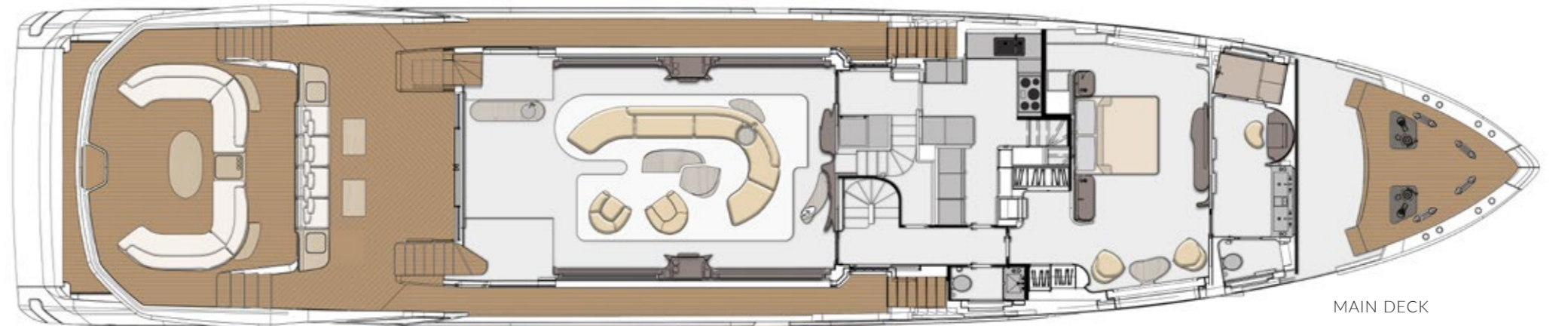

MAIN DECK



LOWER DECK



TRIDECK

THREEDecks+ONE





AZIMUTYACHTS.COM

This brochure in no way constitutes a contract of sale for the boatyard's vessels to any person or company. All information contained herein, including but not limited to technical and performance data, illustrations, and drawings, is non-binding and for purposes of illustration only. The information in this brochure refers to the boatyard's standard motoryacht models available as of the date of publication. Technical and descriptive information is valid only to the extent that it pertains to the specific vessel that is the subject of a purchase. Contract terms are valid only to the extent that they are contained in a contract of sale. This document is based on information available at the time of publication. Despite efforts to ensure the greatest possible accuracy, the information contained herein may fail to cover all details, omit technical or commercial changes that may have been made subsequent to publication, describe features that are not present, and fail to envisage all circumstances that might occur. Any illustrations, photographs, diagrams and examples shown in this brochure are included solely for the purposes of illustrating the text. Due to the different features of each vessel, the boatyard assumes no liability for actual use based on the illustrated applications.