

# MY BAYA





# TECHNICAL SPECIFICATIONS :

BUILDER: Benetti Shipyard, Italy

CODING CERTIFICATION: Commercially coded

DEPARTEMENT EXTERIOR STYLING AND CONCEPT: Giorgio M. Cassetta Yacht & Interior Design

INTERIOR DESIGN: Achille Salvagni Architetti

CONSTRUCTION MATERIAL: GRP/CF

LENGTH OVERALL (LOA): 28.95 mt - 95'

MAXIMUM BEAM: 7 mt - 23'

MAXIMUM DRAFT FULL LOAD: 2 mt - 6' 7"

FULL LOAD DISPLACEMENT: 145 tons

FUEL CAPACITY: 20,000 l - 4,399 US gals

FRESH WATER CAPACITY: 2,500 l - 660 US gals

MAIN ENGINES: 2 x MAN V8 1000 735 kW (1,000 HP) @ 2,300 rpm each ( 1300 engine hours )

MAX SPEED AT HALF LOAD: 13.5 Knots

CRUISING SPEED: 12.5 Knots

RANGE AT 10 Knots: 1,950 Nautical Miles

GENERATORS: 2 x 55 kW 230V AC / 3 phases / 50 Hz

BOW THRUSTER: Electric

STABILIZERS: Electric - underway and at anchor

PROPELLERS: 2 x five nickel - aluminium – bronze blades and hub

ELECTRIC AND ELECTRONIC SYSTEM: BEST (Benetti's Exclusive Sea Technology)

ACCOMMODATION FOR OWNER & GUESTS: 10 Persons 5 Cabins

ACCOMMODATION FOR CREW: 5 Persons 3 Cabins

CLASSIFICATION: RINA C @ Hull • MACH Y

# ADDITIONAL EQUIPMENT :

## MAIN DECK

- Net FILTRAVEDO manual behind the sofa and at the sides of the aft cockpit
- Custom cabinet with icemaker, sink and garbage in the aft cockpit
- Main saloon dining extension from 8 to 10 seats
- Wine cellar for 38 bottles in galley

## MASTER CABIN

- Add one Bathtub in the Owners bathroom keeping the shower in the middle of the 2 bathrooms
- Add one storage in the wall of the bathroom side without the bath
- Integrated W/C/ Bidet in Master and Guests Cabins not dayhead
- Integrated obio in Owner cabin windows

## LOWER DECK

- Garage for 1 dingy up to 4,50 and 1 jetski Garage door foldable and useable as beach club Engine room department

## UPPER DECK

- Ext dining table from 8 to 10 seats
- Bar with top granite
- Small Garbage Under Sink
- Wine Cellar
- BBQ (separate unit on UD aft side)
- Pilot chair wellhouse
- Jacuzzi

# ADDITIONAL EQUIPMENT :

## VARIOUS

- Coffee table sundeck
- Transom backlit yacht name in stainless steel 1,5mm with plexi
- N.6 underwater lights Cantalupi 90 sealed FY9 80W
- Manual awning on Upper Deck aft with Stainless Steel pillar
- Manual awning on Upper Deck forward
- No limestone in the Master and Guests bathrooms
- Tv in VIP cabin to be upgraded from 32" to 43"
- Wheelhouse monitors to be upgraded from 15" to 19"
- Additional monitor 12" on sundeck pilothouse
- Main deck automatic door
- Sat TV cable provision
- Glendinning CM8 for shore power supply with 100A cable
- Stern-thruster BTM40-EA37 220V with stainless steel tunnel
- Upgrade watermaker from Idromar MC3 at 180 lt/h to MC9S at 375 lt/h
- Additional cleats for tender mooring on swim platform
- Foredeck coffee table and sunbeds
- Day Head MD sink modification ref Antonio Lupi Kubic & faucet
- Facets in all bathrooms Zucchetti Savoir stainless steel
- Leather headboard cabins
- Marble matrix leather finish on upper deck bar and stb top
- 2 sofas and 2 armchairs Salvagni
- Custom table plus 4 chairs aft deck cockpit fixed and with extension













































SIDE VIEW

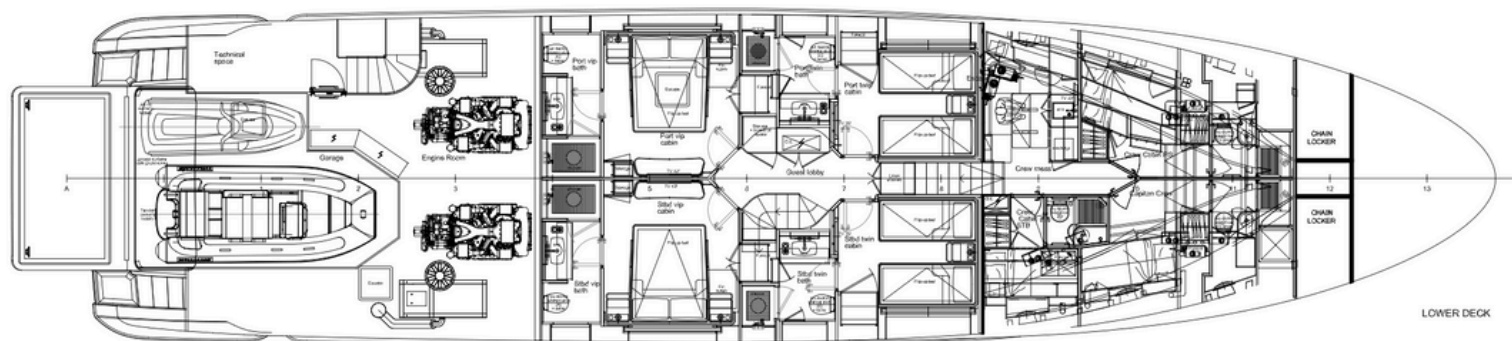

LOWER DECK



